

The **angular extension** is the mechanical accessory to be applied to the instrument to carry out vertical and angular measurements of variable length from 1100mm to 2500mm.

The assembly is done by means of the **fixing element** of the straight extension, the various lengths are assembled with the elements shown in the drawing on the second page.

The angular extension elements are contained in a practical transport bag (length 1000 mm).

Some elements of the angular extension can be used to make the **1500mm** measurement on swing and/or sliding doors.

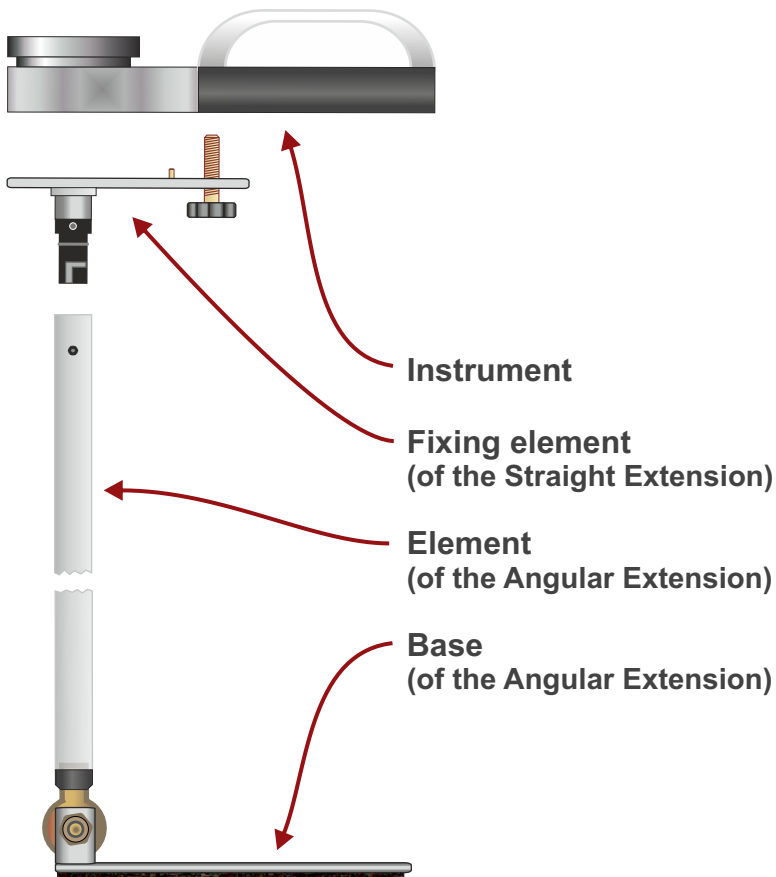

ANGULAR EXTENSION 50V004-C - LENGTH COMPOSITION

A= 200mm element (mechanical stop of straight extension)

B= 200mm element (straight extension)

C= 615mm element (angular extension)

D= 1000mm element (angular extension base)

(element tolerance is $\pm 5\%$)

2500 mm

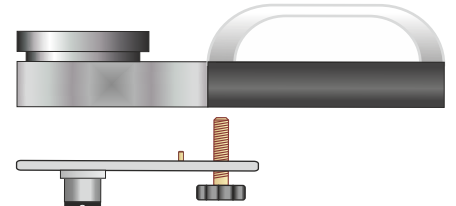

2000 mm

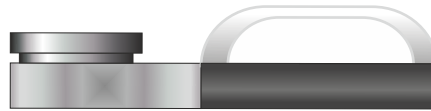

1500 mm



C

C

A

B

C

D

B

C

C

D